

SP-C520F / C640F

5" / 6.5" Frameless Ceiling Speaker



Features:

- Frameless Narrow Edge Shell in Fashion Design
- Coaxial ceiling speaker system
- Power Output: 5" RMS 10W, MAX 20W; 6" RMS 20W, MAX 40W
- ABS+Metal Grille
- With Transformer for the system of 100V

Specifications:

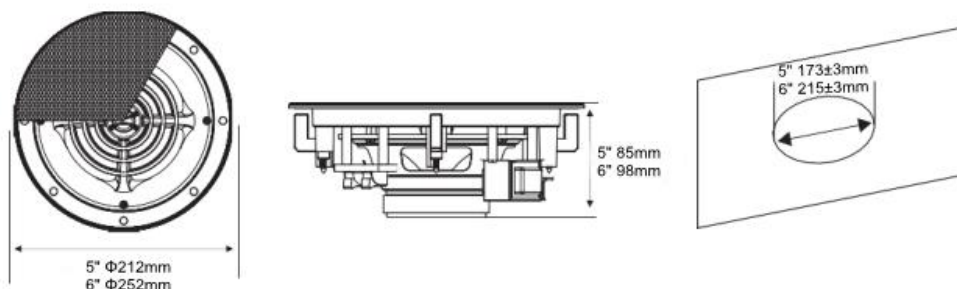

Model No.	SP-C520F	SP-C640F
Power Output	RMS 10W, MAX 20W	RMS 20W, MAX 40W
Input mode	100V	100V
Sensitivity	88 ± 3dB	89 ± 3dB
Frequency Response	100Hz-15KHz	100Hz-16KHz
Speaker Unit	5"*1 + 0.75"*1	6.5"*1 + 0.75"*1
Cutting Hole	Φ173mm	Φ215mm
Dimension	Φ212 × 85mm	Φ252 × 98mm
Material	ABS+Metal Grille	ABS+Metal Grille
Net Weight	1.1KG	1.4KG

Installation:

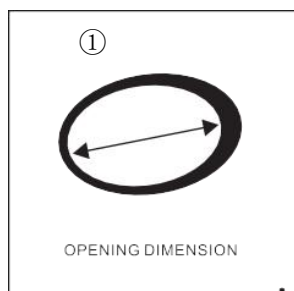

①
Cut hole:
5" Φ 173mm
6" Φ 215mm

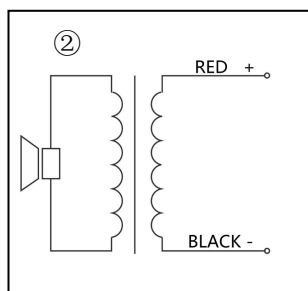

②
Connect wiring
Black: Com
Red: Full Power

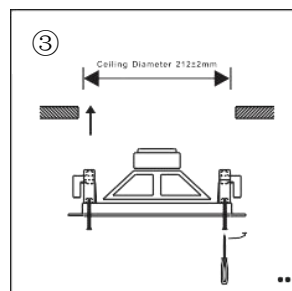

③
Insert ceiling speaker,
tighten the fastening screws
in a clockwise direction.

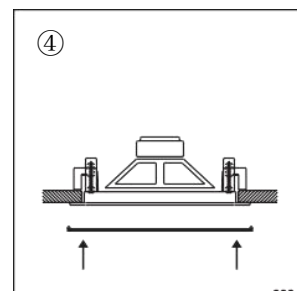

④
Insert the grille