

PA 6 Zone Mixer Amplifier with Phantom Power/Echo/USB/SD/FM/BT

SP-MA660/ SP-MA6120/ SP-MA6240/ SP-MA6350/ SP-MA6500



Features

- ✦ Public address system (PA) 6 zone commercial mixer power amplifier.
- ✦ 19" rack mount amplifier of 2U height with rack mount ears.
- ✦ Rated outputs of 60W, 120W, 240W, 350W to 500W.
- ✦ Built-in Mp3 player by USB & SD and FM tuner and Blue tooth
- ✦ 6 zone speaker outputs of 100V or 70V.
- ✦ Six zone speaker outputs with independent volume control.
- ✦ Four microphone inputs, Mic1(6.3mm) and Mic/Line input 2-4 (XLR).
- ✦ Line 1-2 inputs on rear panel by RCA.
- ✦ EMC input on rear panel with highest priority by RCA.
- ✦ One amplifier capacity of 6 remote paging microphones SP-RM6 up to 300 meters.
- ✦ Microphone1 of VOX features of highest input priority except EMC input.
- ✦ Volume control for Mic1-4 and line 1-2, bass & treble and zone volume control on front panel.
- ✦ AC and DC Power, protection, clip six zone status indicators and output level meters.
- ✦ Overload, short circuit, clip and high temp protection.
- ✦ AC 230V and DC24V operation system.

Specification

Model	SP-MA660	SP-MA6120	SP-MA6240	SP-MA6350	SP-MA6500
Description	Public Address System Six Zone Mixer Amplifier				
Rated Power Output	60W	120W	240W	350W	500W
Speaker Output	70V, 100V, 6 zone speaker out 100V				
Input	Mic1-3: 600 ohms(Ω) 5-8 mV, unbalanced, Line1-2: 10k ohms(Ω) 150-470 mV, unbalanced				
Frequency Response	60-15KHz				
THD	<0.5% at 1kHz, 1/3 rated power				
S/N Ratio	Line: 85 dB , MIC: >72 dB				
Protection	High temp, short circuit, overload protection				
Power Supply	AC230V or AC110V, 50-60Hz				
Power Consumption	100W	200W	400W	500W	600W
Dimension	418(W) \times 318(D) \times 88(H)mm				
Gross Weight	8.2kg	9.5kg	12.0kg	13.0kg	14.5kg

Application

It is ideal for BGM and speech use

Mosque, School, Super Market, Bank, Hotel, Restaurant, Theme Centers and Shopping Center.

Front Panel

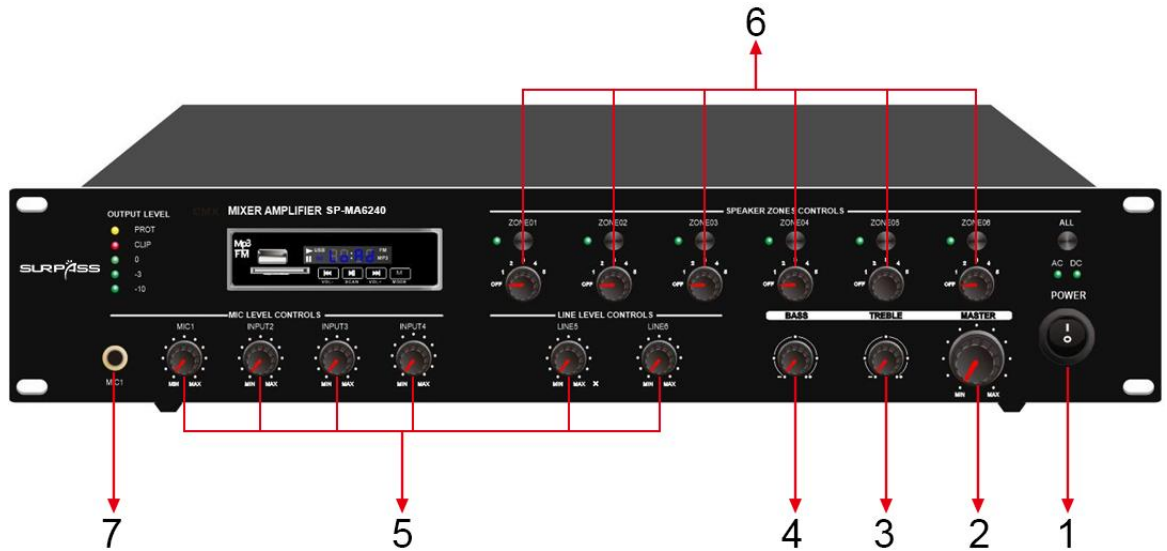

- 1. Power switch
- 2. Master control
- 3. Treble control
- 4. Bass control
- 5. MIC1, INPUT2, INPUT3, INPUT4, LINE5, LINE6, Level Control
- 6. Zone01, Zone02, Zone03, Zone04, Zone05, Zone06, Speaker Zone Control
- 7. MIC 1 Input

Rear Panel

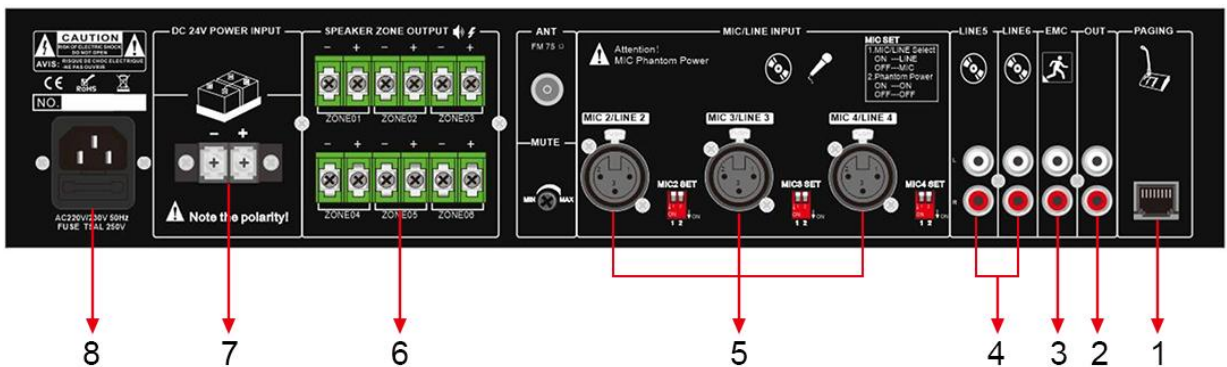

- 1. Paging jack
- 2. Output jack
- 3. EMC Input
- 4. Line 4, 5 Inputs
- 5. MIC 2/LINE 2, MIC 3/LINE 3, MIC 4/LINE 4 Inputs Speaker Zone output
- 6. Zone01, Zone02, Zone03, Zone04, Zone05, Zone06, Speaker output
- 7. DC 24V Power input
- 8. AC power cord

Support Remote Microphone:

